



## 7.5ft Curved Pop Up Display(Frame only)-Spring Connection

Item Code: SIC-PUB-B-1



FOB Price: **\$231/set**

Mini Order: 1 set

Shipping Weight: ★★★★★

Average Rating: 133.1lb (60.48kg)

[Inquire Now](#)

### Overview

#### Feature:

. 7.5ft curved pop up display with spring connections. Magnetic panels to combine a whole unity. This is the traditional one.

#### Includes:

- . Curved aluminum frame with spring connections
- . 18 magnet bars
- . 10 plastic strips
- . 23m magnet tape
- . 5 PVC panels
- . Hard plastic case

#### Description:

This trade show display is the attractive mural backdrop for exhibit booths. The 7.5ft wide area is perfect for expansive images and messages. This pop up display is easy to assemble. Users expand the truss simply by pulling it open. The display frame then latch in place with provided springs. Assembling the unit will take less than 10 minutes! The trade show display is very vibrant and attractive. Every set pop up display comes with a heavy duty travel case at no extra cost. The travel case includes roller wheels, dual handles, and lock-and-key security.

**Application:**

This pop up display is suitable for various kinds of exhibition, convention, trade fairs and promotion activities.

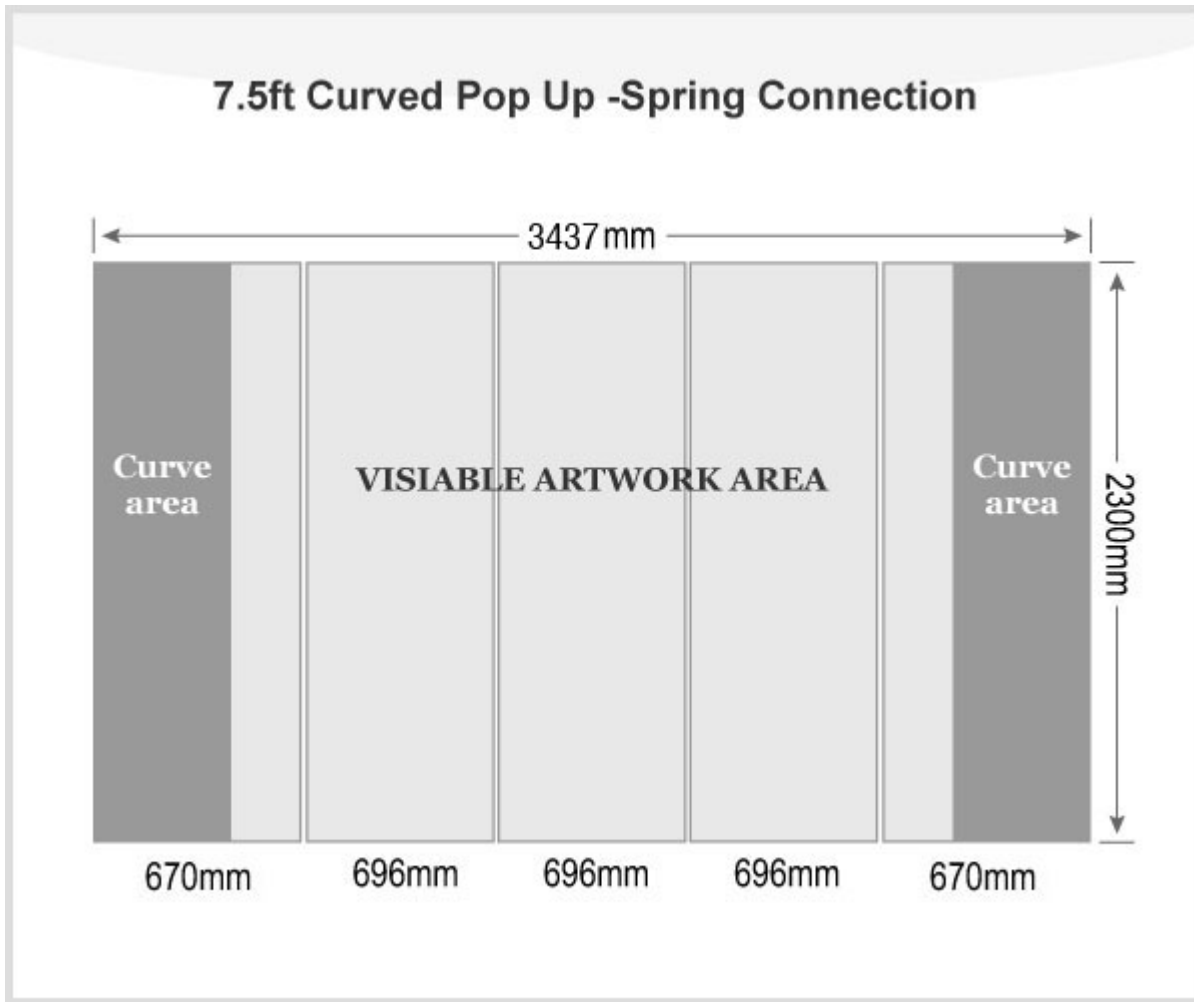

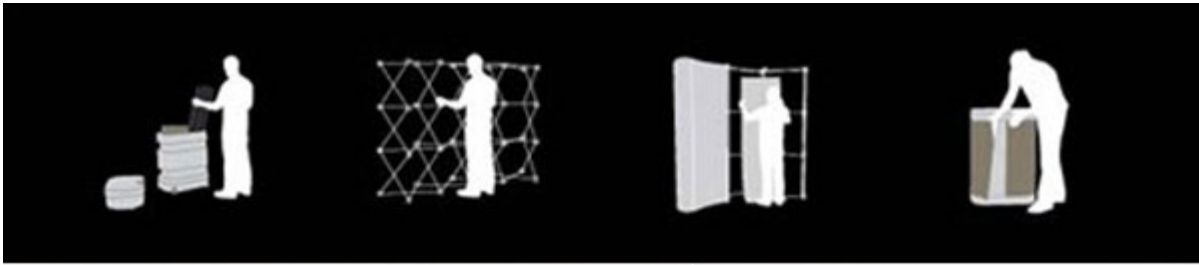

one set frame



carrying case



optional light

## POP UP SYSTEM - SET UP INSTRUCTIONS



- 1, You will find all the needed components in the carrying case



- 2, Remove frame, magnetic bars and the graphic panels from the carrying case

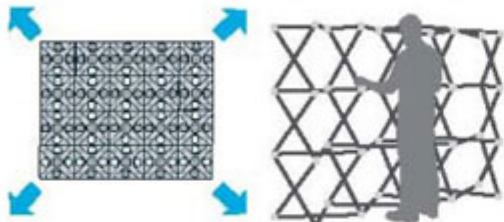

- 3, Place the frame on the floor with hubs with graphic hangers facing up and towards you. Grasp frame scissors and lift to expand frame

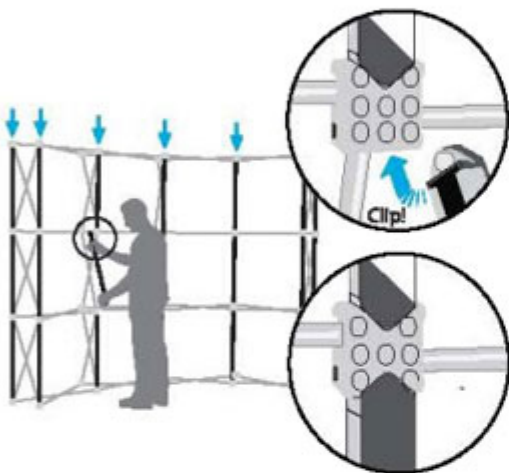

- 4, Apply the bars to all vertical quadrants on front side of the frame and to each end on back side of the frame. For a double sided frame, apply the bars also on the back side of the frame.

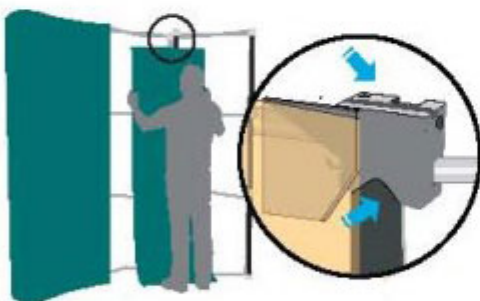

- 5, Hang the graphic panels on the top hub-hangers letting panels attach to bars. Do the same on both end-caps of the frame.



- 6, Close the transport case, put the black table top

## Details

Material	Aluminum
Frame size	90.2" W x 90.6" H(229cm W x 230cm H)
Package size/ctn	28"x17"x39"(72x42x100cm)
G.W./ctn	69.7lb(31.7kg)
Graphic	Without
Shape	Curved
Frame size	7.5ft



Copyright © 1999-2012 by Beijing ChinaSigns Information Company Limited All Rights Reserved.

Email:info@sign-in-china.com Tel:+86 132 6410 3286 www.sign-in-china.com