



7.5ft Curved Pop Up Display(Frame only)-Magnetic Connections

Item Code: SIC-LW-002



FOB Price: **\$373/set**

Mini Order: 1 set

Shipping Weight: ★★☆☆☆

Average Rating: 133.1lb (60.48kg)

[Inquire Now](#)

Overview

Feature:

. 7.5ft curved pop up display with magnetic connections. Magnetic panels to combine a whole unity. Magnetic connections can be more convenient.

Includes:

- . Curved aluminum frame with magnetic connections
- . 18 magnet bars
- . 10 plastic strips
- . 23m magnet tape
- . 5 PVC panels
- . Hard plastic case

Description:

This trade show display is the attractive mural backdrop for exhibit booths. The 7.5ft wide area is perfect for expansive images and messages. This pop up display is easy to assemble. Users expand the truss simply by pulling it open. The display frame then latch in place after you connected the magnetic blocks. Assembling the unit will take less than 10 minutes! The trade show display is very vibrant and attractive. This pop up exhibit includes a molded hard plastic case. This trade show display case features built in wheels for easy transport of booth materials. The carrying case makes this unit perfect for those users on the go.

Application:

This pop up display is suitable for various kinds of exhibition, convention, trade fairs and promotion activities.

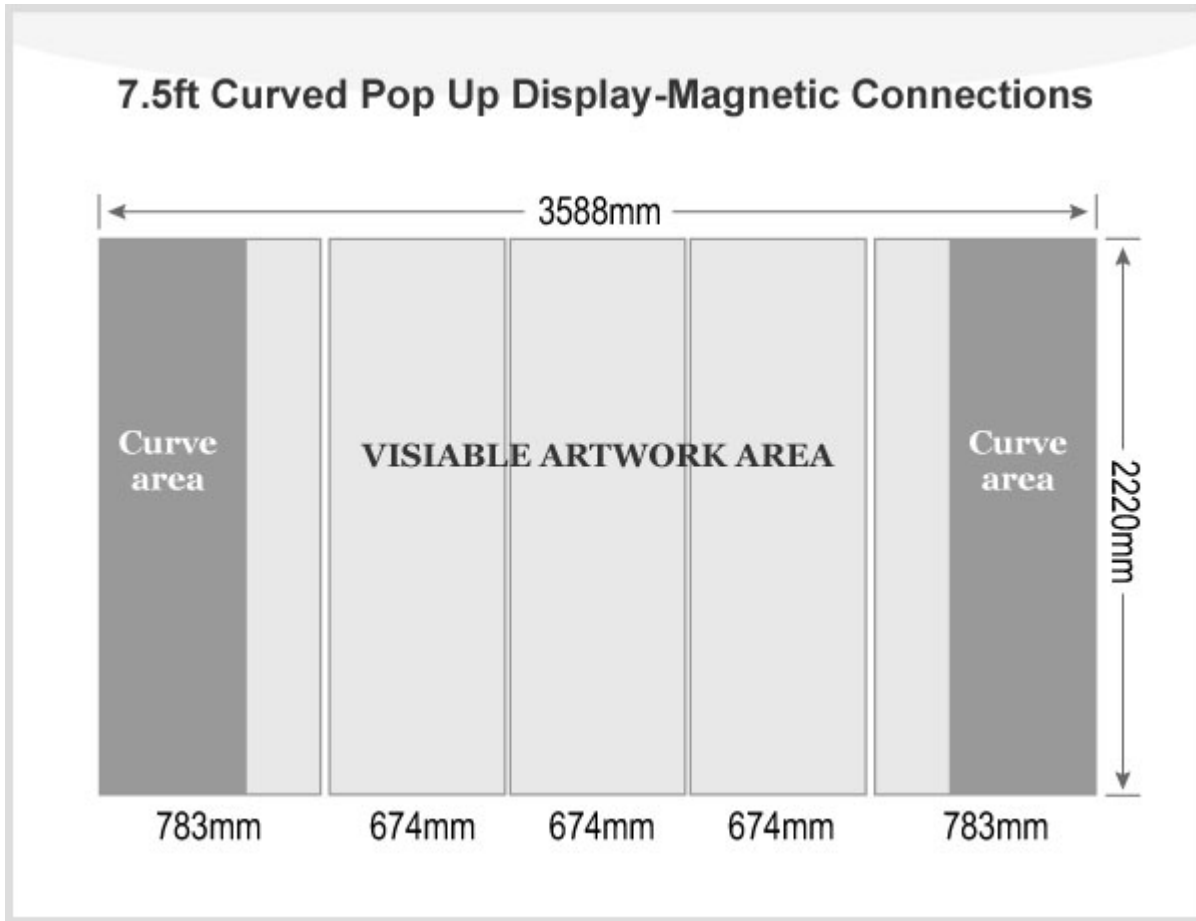

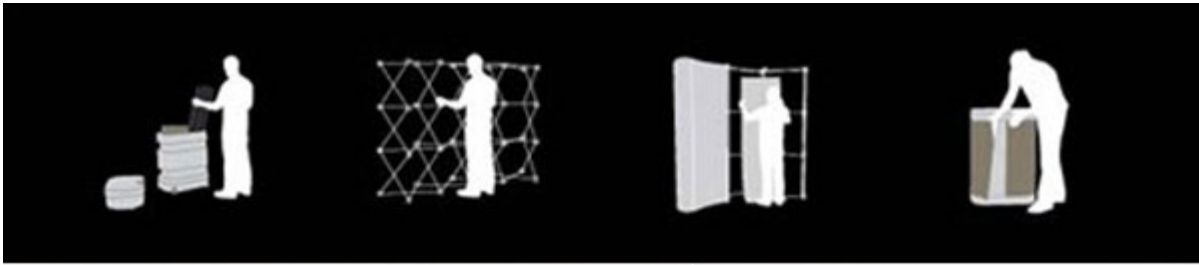

one set frame



carrying case



optional light

POP UP SYSTEM - SET UP INSTRUCTIONS



- 1, You will find all the needed components in the carrying case



- 2, Remove frame, magnetic bars and the graphic panels from the carrying case

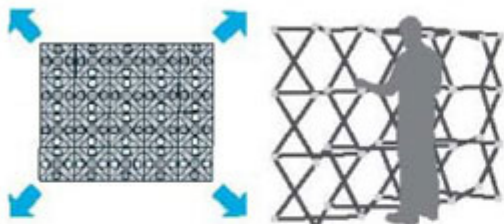

- 3, Place the frame on the floor with hubs with graphic hangers facing up and towards you. Grasp frame scissors and lift to expand frame

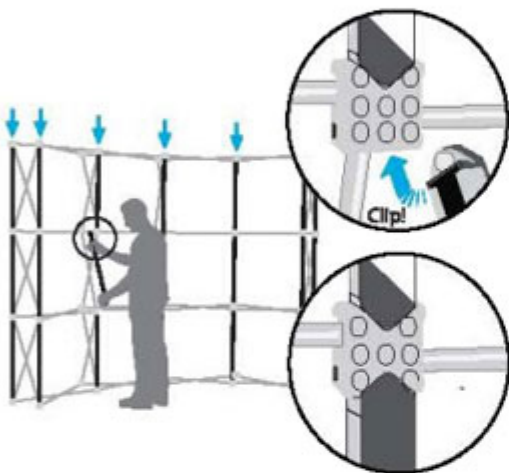

- 4, Apply the bars to all vertical quadrants on front side of the frame and to each end on back side of the frame. For a double sided frame, apply the bars also on the back side of the frame.

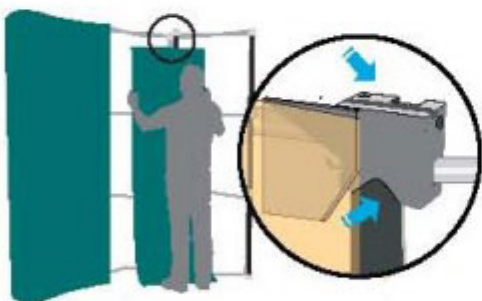

- 5, Hang the graphic panels on the top hub-hangers letting panels attach to bars. Do the same on both end-caps of the frame.



- 6, Close the transport case, put the black table top

Details

Material	Aluminum
Frame size	80" W x 87.5" H(203cm W x 222cm H)
Package size/ctn	28"x17"x39"(72x42x100cm)
G.W./ctn	71.7lb(32.6kg)
Graphic	Without
Shape	Curved
Frame size	7.5ft

Tags

[Pop up display](#) [pop up display stand](#) [pop-up display systems](#) [Popup displays](#) [pop up stand](#) [Curved Pop Up Display stand](#)



Copyright © 1999-2012 by Beijing ChinaSigns Information Company Limited All Rights Reserved.

Email:info@sign-in-china.com Tel:+86 132 6410 3286 www.sign-in-china.com